

Panlite[®]MRsheet

**PC Sheets for
Head-up Display (HUD)
Dust Covers**

PC Sheets for HUD Dust Covers

Product overview:

Panlite® MR sheet PC-813A (single-sided MR) and PC-8H30 (high retardation single-sided MR) are polycarbonate sheets optimized for use as HUD dust covers.

Features:

Surface hardness

Extremely high surface hardness compared to conventional hard-coated products.

Transparency

High transparency suitable for displays.

Durability

Retains performance even when exposed to high temperatures and high humidity for long time.

Chemical resistance

Outstanding chemical resistance.

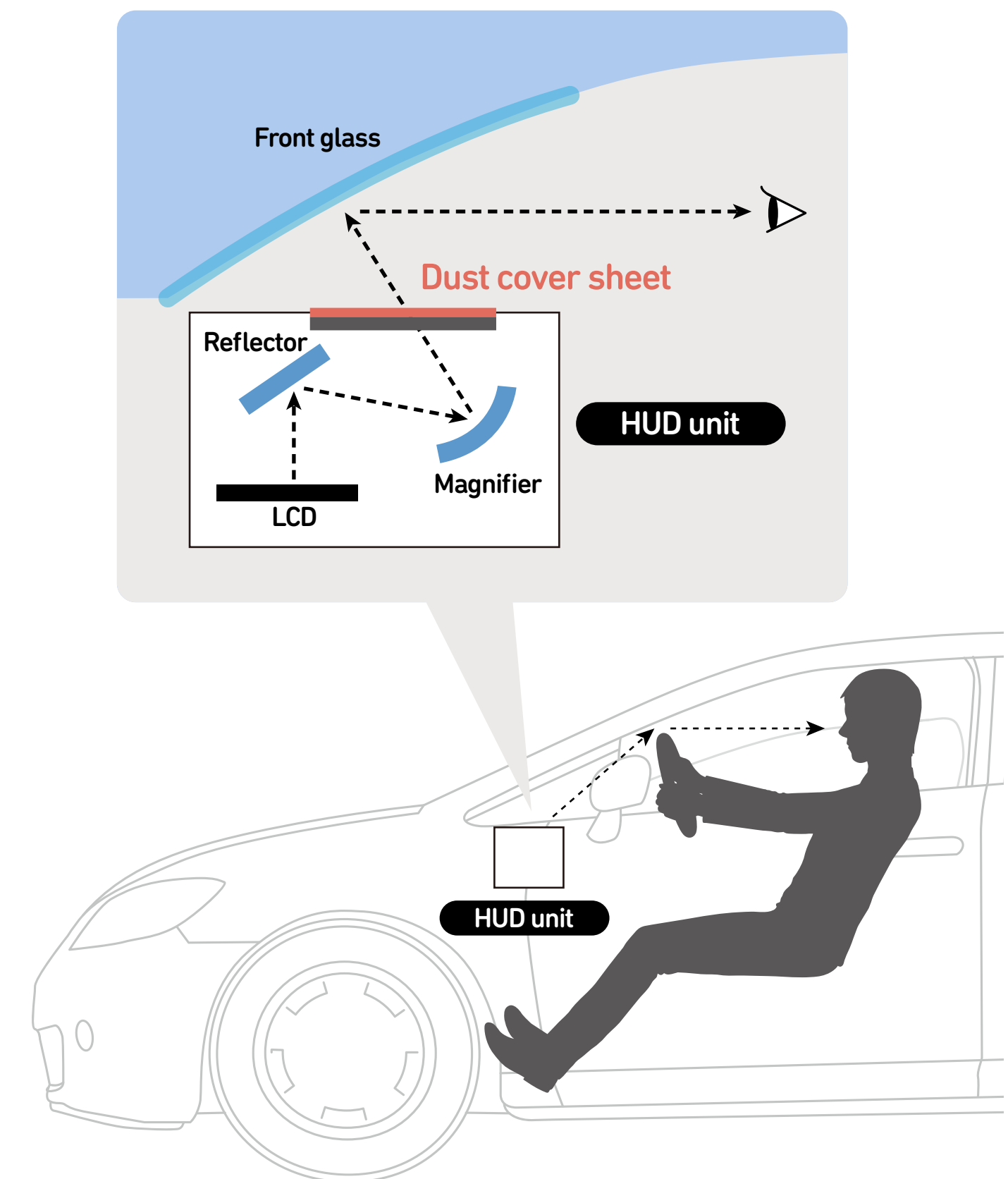

PC Sheets for HUD Dust Covers

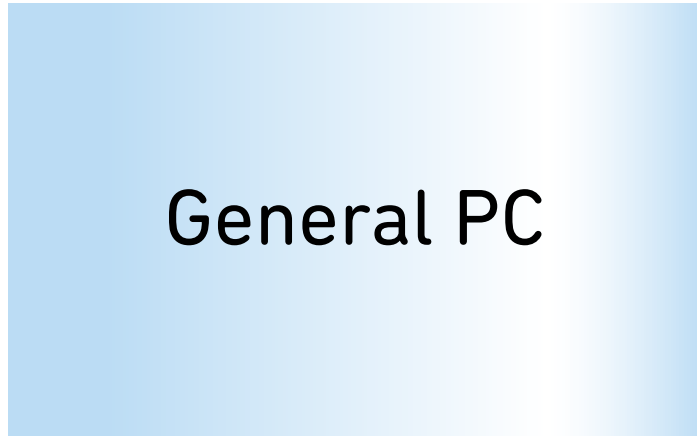
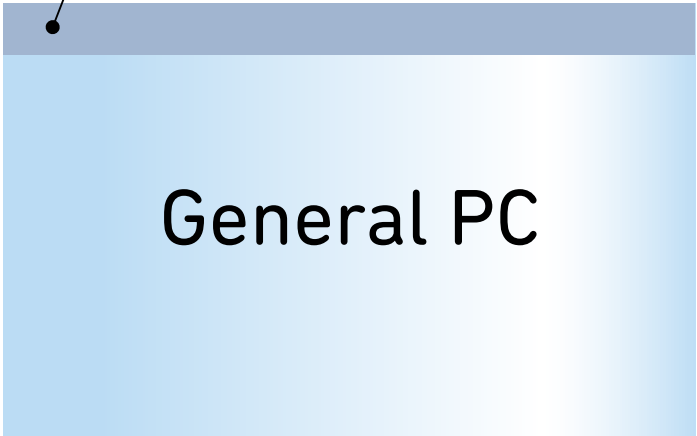
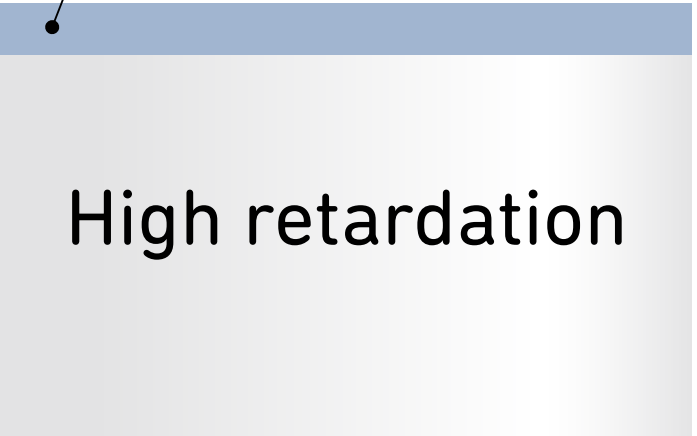
Grade	PC-1151	PC-813A	PC-8H30
Sheet configuration	 <p>General PC</p>	 <p>Hard coat General PC</p>	 <p>Hard coat High retardation</p>
Sheet thickness	0.3~2.0mm	0.35/0.5mm	0.38mm
Retardation control	None	None	High retardation (3,000nm \leq)

Retardation performance, and double-sided hard coats also available, based on the current PC-813A model.

Physical Properties

Evaluation conditions:

- **Transparency**

JIS-K7136 and ISO 11664-4 compliant

- **Retardation**

KOBRA-WFD (Measurement wavelength 589nm)

- **Hardness**

JIS-K7204 compliant (100 spins)

JIS-K5600 compliant (750gf)

- **Heat resistance 110°C × 2,000hr**

Adhesion JIS-K5600 compliant

- **Resistance to moist heat**

60°C×95%RH×1,000hr

JIS-K5600 compliant

- **Chemical resistance 24hr immersion**

(1% sulfuric acid, 1% NaOH, ethanol, gasoline)

	Evaluation item	PC-1151	PC-813A	PC-8H30 (High retardation)
		1.0mm	0.35mm	0.38mm
Transparency	Total light transmittance (%)	89	91.9	91.9
	Haze (%)		0.2	
	Hue value b*		0.2	
Retardation	Re (nm)	—	—	3,000 ≤
Hardness	Taber hardness	25	3	3
	Pencil hardness	2B	B~HB	B~HB
Heat resistance	Appearance (visual)	—	No change	No change
	Adhesion (cross cut)	—	○	○
Resistance to moist heat	Appearance (visual)	—	No change	No change
	Adhesion (cross cut)	—	○	○
Chemical resistance	Appearance (visual)	—	No change	No change

*The values listed are typical values, not certified values.